

The Yashar Family

Welcome to the Yashar Mains Mosaic Large track accent light, available in 120 volts. The yoke mounted Mosaic Large heads feature integral drivers mounted in the track adaptor. Available driver types include 0-10 volt, DALI and phase dimming options. A smaller profile version is available in the Yashar Mains Mosaic Medium Head. You have found the Yashar Mains Mosaic Large track head compatible with Yashar Mains Track. We hope that you enjoy the details.

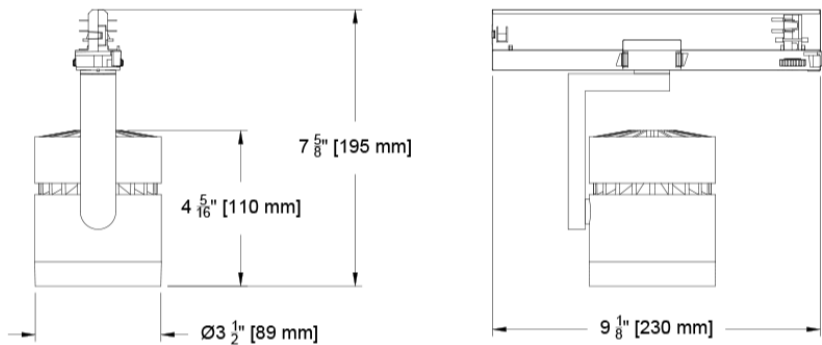

PROJECT:

TYPE:

SPECIFIER:

DATE:

Key Points (YSMH-MSC-L)

Housing

- Track accent head for use in Yashar Mains Track.
- Die-cast aluminum housing with twist off bezel assembly for access to accessories and optics.
- Available in Black or White painted finish
- Yoke mounted head, adjustable 360° degree rotation and 90° degree tilt.
- Track mounted with integral drivers in track adaptor fitting.

Source / Optics

- 4 beam spreads - 18°, 28°, 35° and Wall Wash options available
- Fixture can take up to two lens accessories.
- Up to 3513 delivered lumens
- <2 MacAdams Ellipses (<2 SDCM) for fixed white
- 90+ CRI, 60+ R9 Standard, 95+ CRI, 90+ R9 available with Ambient Dim option
- CCT available in 2400K, 2700K, 3000K, 3500K, 4000K
- **TITLE 24** Fixture supports CA Title 24 compliance meeting JA8 requirements
- Lifetime: L87B3>55,000 hours at 40°C Ambient

Driver And Control

- 120 volt
- 0-10 volt, phase and DALI. DALI control enables individual control of each fixture.
- For track mount heads, 0-10 volt dimming control provides single zone of dimming control on 120 volt (2 or 3 circuit track) as the circuits are combined on the 0-10 volt control side. For two circuit applications ELV/Triac drivers are available to dim each circuit separately, as there is a separate neutral for each circuit. We do not recommend using the ELV/Triac drivers in three circuit applications, because the three circuits share a common neutral. Refer to YSMT cutsheets for details on voltage and circuiting.

Ordering Codes

PROJECT:SPECIFIER:

DATE:TYPE:QUANTITY:

Ordering Code Example: YSMH-MSC-L-1-C24-30-28-TD1-B-91L

FIXTURE	SOURCE / WATTS	CCT	BEAM	DRIVER / CONTROL	HEAD FINISH	LENS ACCESSORIES
YSMH-MSC-L						
Yashar Mains Mosaic Head - Large	Citizen					Reflector (lamp) Media
	C17 20W 1989Lm* 90+CRI, 60+R9	24 2400K	18 Spot	TD1 0-10V 2.0%, (120-277V) linear	B Black Paint	91L Solite
	C24 29W 2757Lm* 90+CRI, 60+R9	27 2700K	28 Narrow Flood	TD2 DALI-2 1.0%, (120-277V) linear	W White	97L Black Hexcel Louver
	C32 38W 3513Lm* 90+CRI, 60+R9	30 3000K	35 Flood	TD3 ELV/Triac 5.0%, (120-120V) linear		XXL Other reflector (lamp) media*
	CA Title 24 Compliant	35 3500K	WW Wall Wash		Note: Aperture Trim Bezel is black in all finishes.	XB Cross Baffle
	* Based on 28° Beam	40 4000K				*Not applicable with Wall Wash



Dimensions

Yashar Mosaic Large Track Head

Standard Mount

(YSMH-MSC-L-)

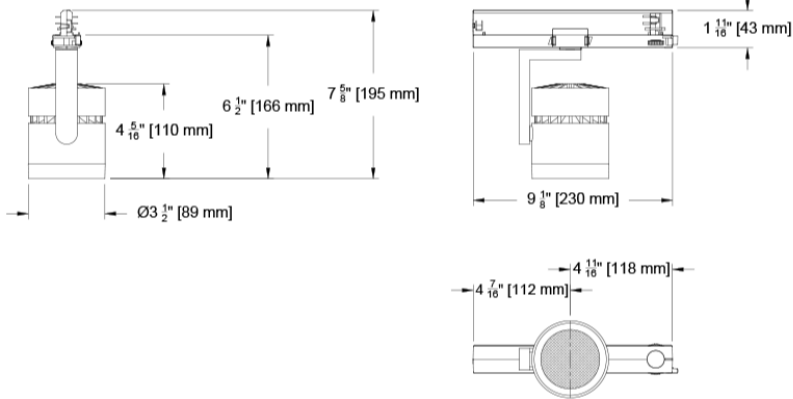

Yashar Mosaic Large Track Head

Standard Mount / Wall Wash

(YSMH-MSC-L-WW)

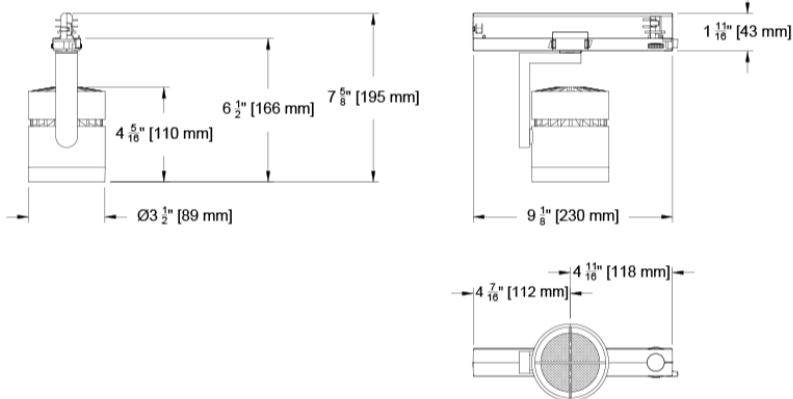

Yashar Mosaic Large Track Head

Standard Mount/Cross Baffle

(YSMH-MSC-L-XB)

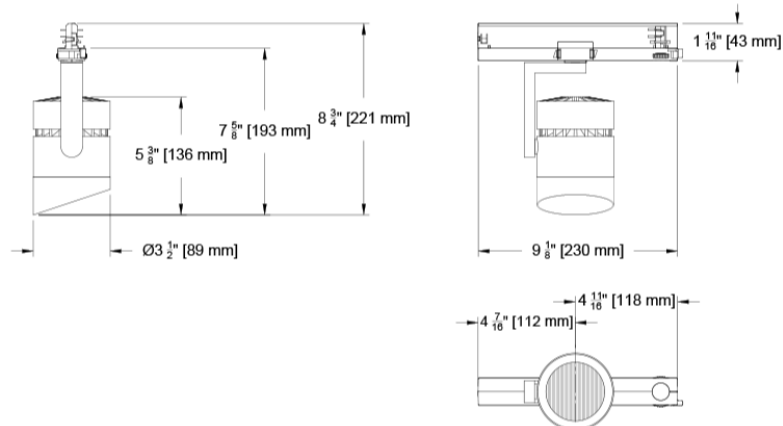

Photometric Table All data below are delivered lumens based on goniometer measurements of production representative product. All lumen values can vary +/- 10% from LED manufacturer rated nominal flux.

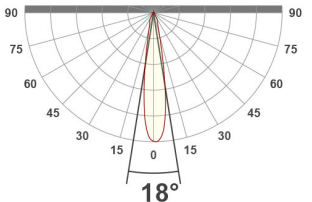
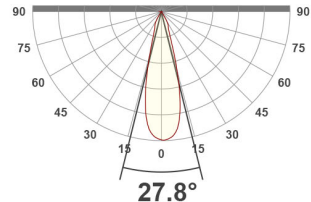
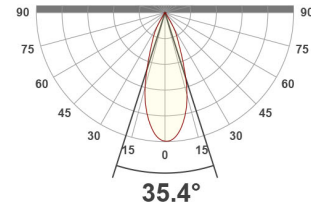
Round Beamspreads		18°				28°				35°			
Source	System watts (W)	Delivered Lumens (lm)	Lumens/ Watt	Peak CD	10% Field	Delivered Lumens (lm)	Lumens/ Watt	Peak CD	10% Field	Delivered Lumens (lm)	Lumens/ Watt	Peak CD	10% Field
Citizen C17	20	1928	96	11737	39°	1989	99	7118	57°	1975	99	4982	63°
Citizen C24	29	2646	93	16324	39°	2757	97	9845	57°	2719	95	6875	63°
Citizen C32	38	3380	90	20933	39°	3513	93	12636	57°	3490	93	8847	63°
CCT Multiplier		Beam angle				Beam angle				Beam angle			
CCT	Citizen	18°				27.8°				35.4°			
2700	0.95												
3000	1.00												
3500	1.02												
4000	1.03												
All measurements are delivered lumens based on 3000K unless otherwise noted below.													

ISO cd Plots based upon C32 Source. Refer to photometry tab on product page for exact ICO cd plot and IES files.

Color Data

All data below are delivered lumens. Color and flux information based on goniometer measurements of production representative product. All values can vary +/- 10% from LED manufacturer data range as listed on their datasheet.

Citizen Source C17, C24, C32

- <2 MacAdam Ellipse (<2 SDCM)
- 90+ CRI and RF
- 60+R9, Hue Bin 1

